

**PANIC / FIRE EXIT  
SURFACE MOUNTED  
VERTICAL ROD DEVICES**

**INSTALLATION INSTRUCTIONS**

**NARROW STILE DESIGN**

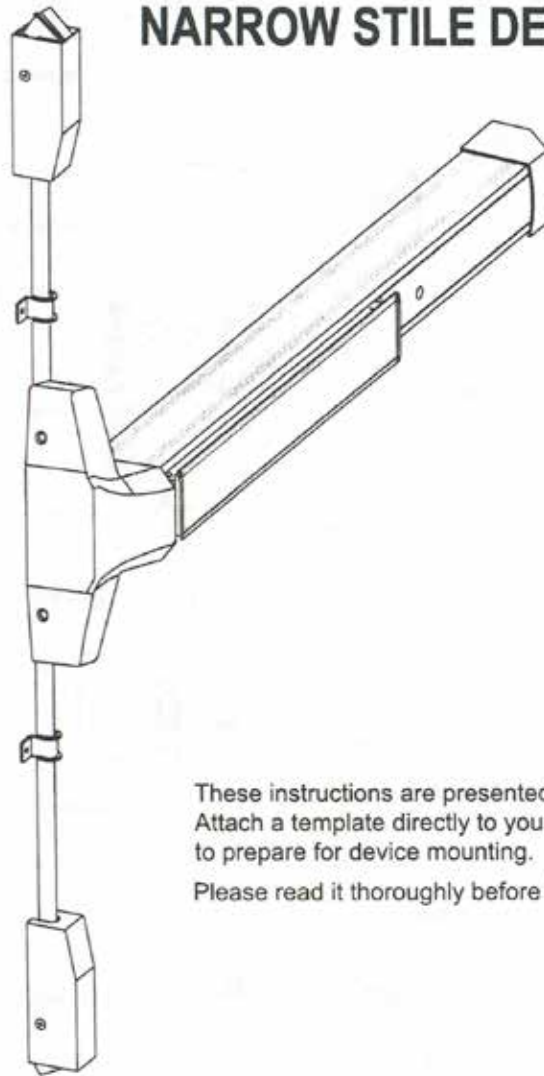

These instructions are presented in step by step sequence.  
Attach a template directly to your door and frame as an aid  
to prepare for device mounting.

Please read it thoroughly before installation.

Not to Scale

The use of non-clutching impact drivers to install this hardware will automatically void the warranty.

## DESIGNATION OF PARTS

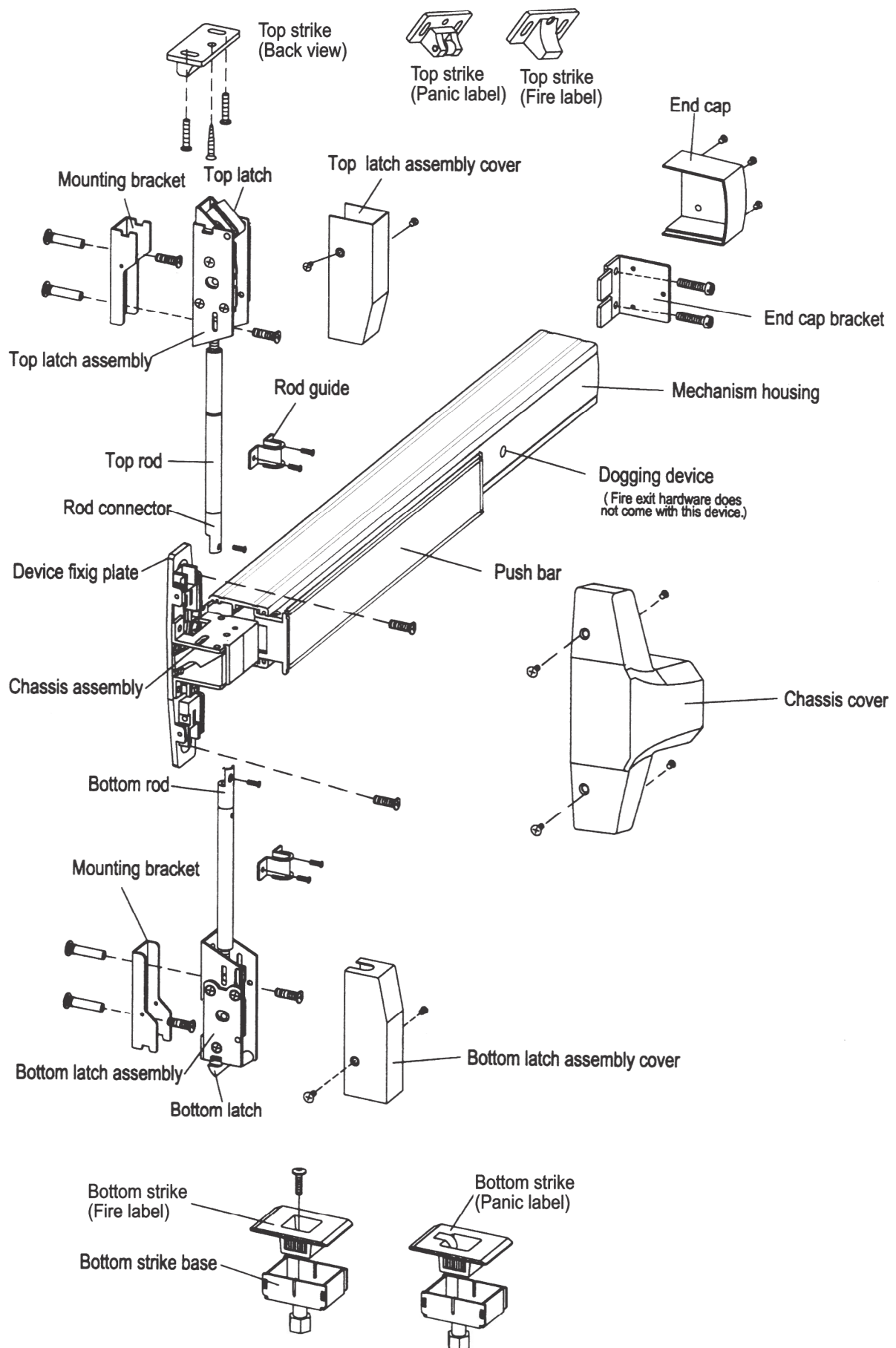

## BEFORE INSTALLING THIS EXIT DEVICE :

1. Check device to be sure the type is correct for the application.
2. Check device for the correct length, finish and outside trim to be used.

### STEP 1: PREPARE DOOR

1. Mark position of holes on the door by templates. (See Fig. 1.)
2. Spot and drill all holes as marks on door for device chassis, top & bottom latch mounting brackets, end cap bracket.
3. Mortise holes for outside trim if required.

*Note :*

*Any hole drilled from the outside need pilot holes drilled from the inside to ensure good alignment.*

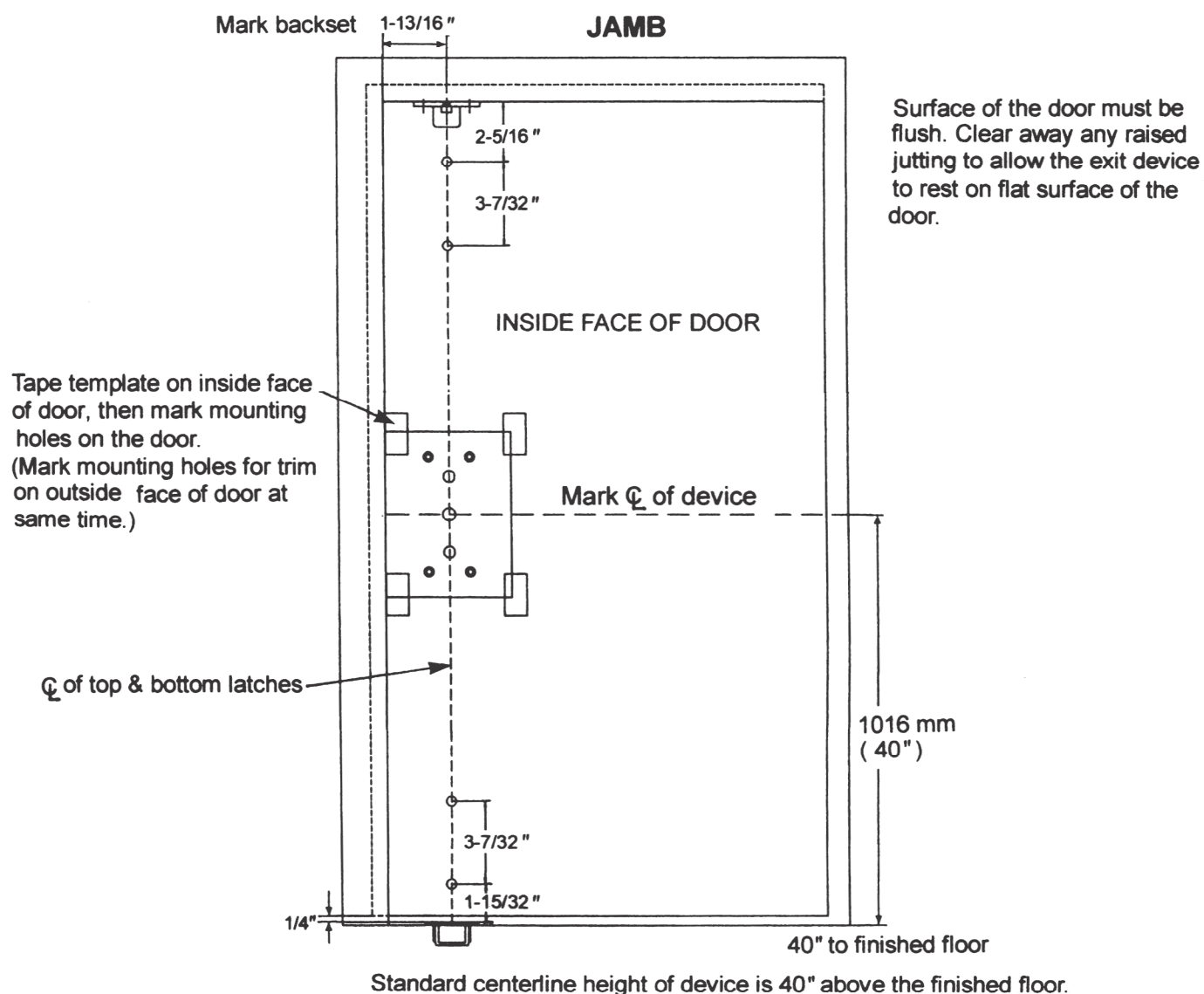

Figure 1

## STEP 2 : INSTALL BRACKETS, DEVICE & TRIM

1. Remove chassis cover from chassis assembly and end cap from end cap bracket.
2. Cut the length if required.

For user information : this model device has 3 different lengths.

For use on 3' wide door device = Approx. 33"

For use on 3.5' wide door device = Approx. 40"

For use on 4' wide door device = Approx. 44"

The lengths of devices are precut for 36", 42" and 48" wide door use, no additional cutting is necessary. If narrow door installation is needed, cut device "A" portion to door width minus 4" to fit properly.

**Note:**

*If cutting is necessary, device must be cut plain and clean all burrs for proper end cap fit.*

3. Mount device horizontally to the drilled position by supplied mounting screws securely, and bolt device chassis to trim or sex bolts if using. (See Trim Installation Instructions.)
4. Make sure trim actuating shaft can insert into device cam. (Ref. View "+" for cam description.)
5. Install end cap bracket on device then screw to door. (Make sure device is level.)
6. Install two mounting brackets on top and bottom of the door. (See Fig. 2.)

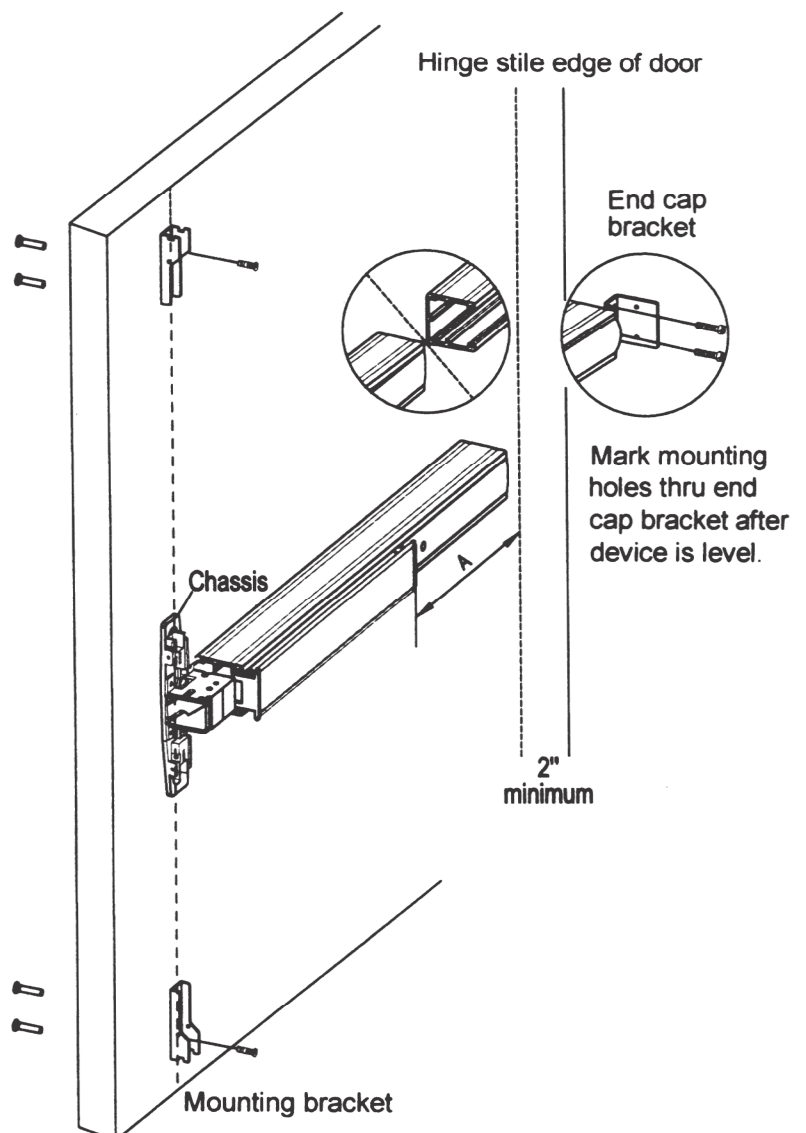

Figure 2



### STEP 3 : INSTALL BOTTOM LATCH, BOTTOM ROD & STRIKE

1. Mount bottom latch assembly into mounting bracket. (See Fig. 3.)
2. Screw the threaded end of bottom rod into bottom latch assembly. (See Fig. 4.)

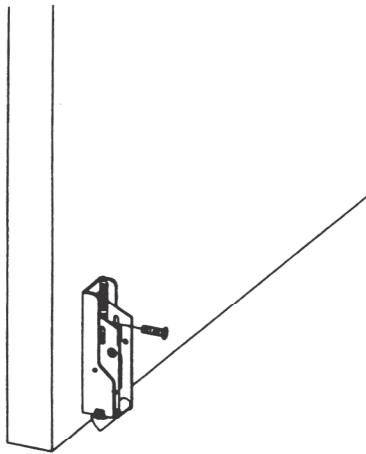

Figure 3

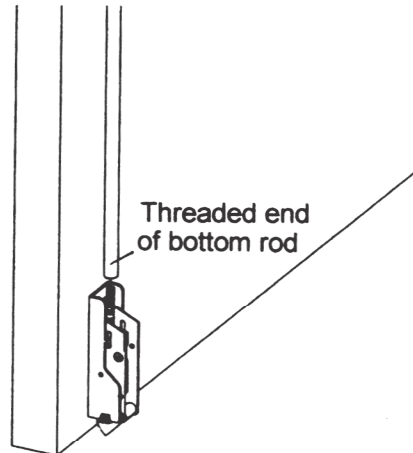

Figure 4

3. Tighten bottom rod on arrow mark position of chassis assembly. (See Fig. 5.)

*Note : If the hole of bottom rod connector does not match in alignment with the mounting hole , to adjust the overall length by turning rod in or out of latch assembly.*

4. Install bottom strike into finished floor or threshold, and be sure to align center line of bottom latch with center line of bottom strike. (See Fig. 6.)

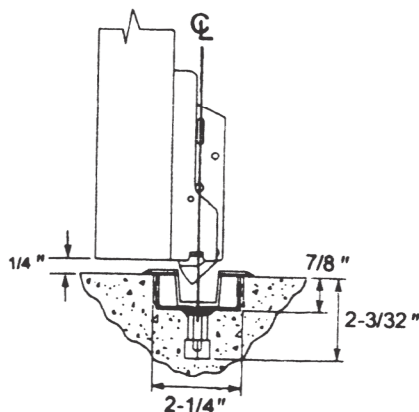

Figure 6

5. Depress push bar and release for checking correct installation:

5-1 Make sure bottom latch can be held retracted and flush with the edge of door when push bar is depressed.

5-2 Check bottom latch bolt has 19/32" (15mm) throw minimum when push bar is released.

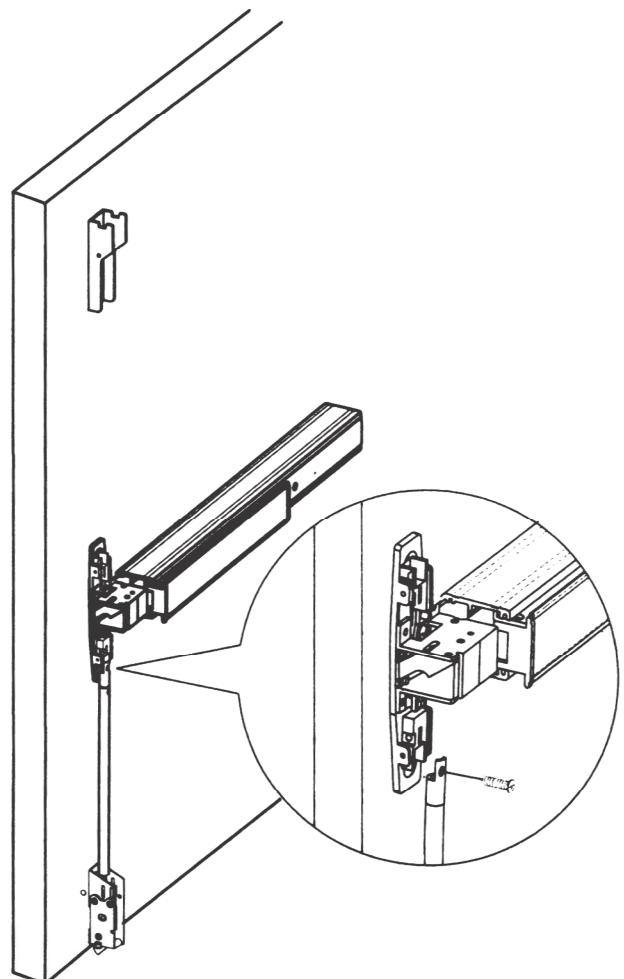

Figure 5

## STEP 4 : INSTALL TOP LATCH, TOP ROD & STRIKE

1. Mount top latch assembly into mounting bracket. (See Fig. 7.)
2. Screw the threaded end of top rod into top latch assembly completely. (See Fig. 8.)

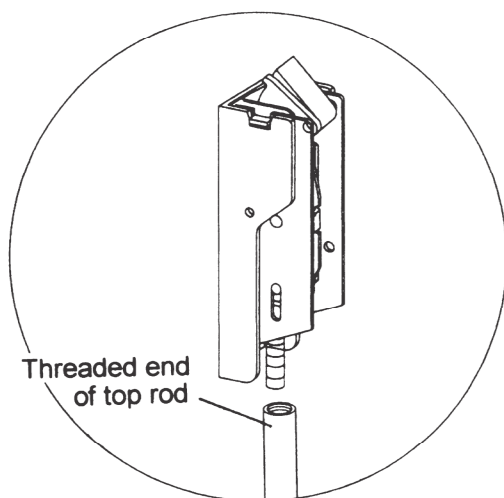

Figure 8

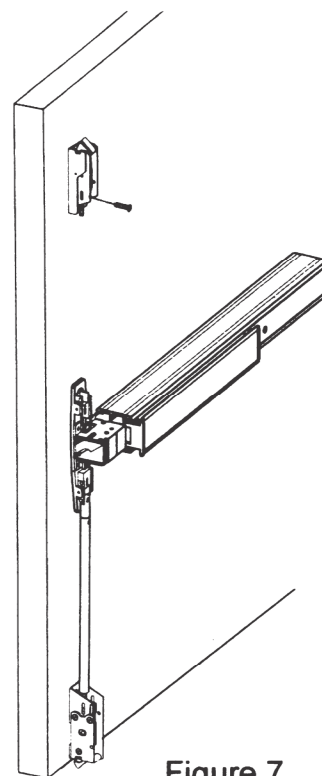

Figure 7

3. Measure and cut the length of top rod. The length of top rod is measured to the edge of rod connector which is going to be fastened on arrow mark position of chassis assembly in next step. Mark the cutting line then cut the excess portion. (See Fig. 9.)
4. Insert rod connector into the non-threaded end of top rod and fasten the setting screw securely. (See Fig. 10.)

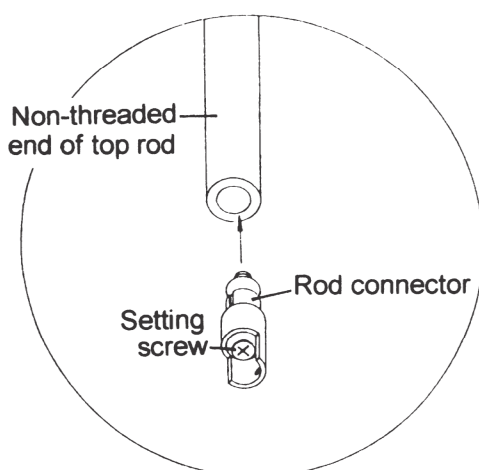

Figure 10

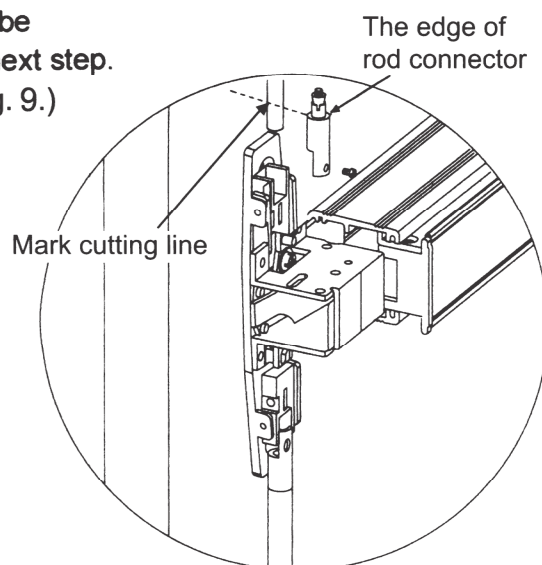

Figure 9

5. Tighten top rod with rod connector onto arrow mark position of chassis assembly. (See Fig. 11.)

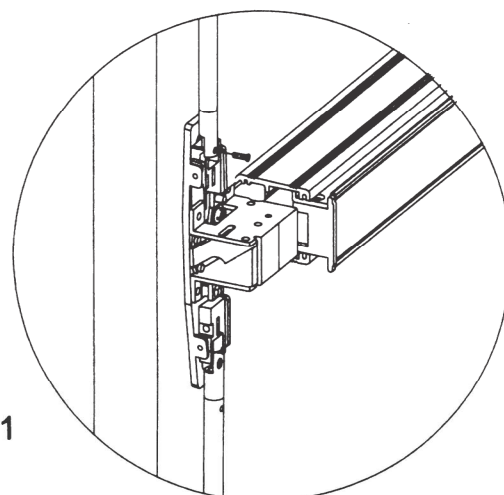

Figure 11

6. Mark mounting holes for top strike on jamb by Strike Template (see Fig. 12.) then fasten with supplied screws. (See Fig. 13.)

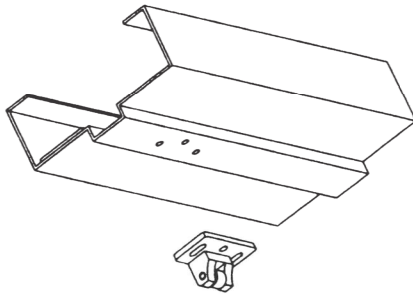

Figure 12

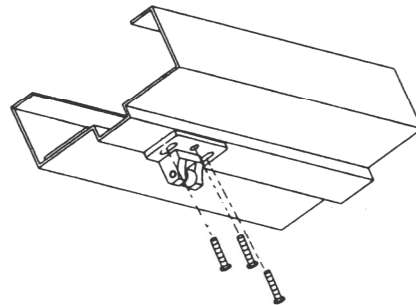

Figure 13

### STEP 5 : TEST OPERATION

1. Depress push bar, top latch should be held retracted. While top latch bolt is retracted, the bottom latch clears floor and bottom strike at same time then door will be opened.
2. Release push bar, both top latch bolt and bottom latch bolt should be full extended.
3. Check device operation by depressing and releasing push bar for several times to assure final correct installation.
4. Repeat device operation by opening and closing door for several times with outside trim to make sure all installation no problem.
5. Redo adjustment procedure if either top latch bolt is not held retracted or bottom latch bolt does not clear floor and bottom strike.

### STEP 6 : INSTALL COVERS

1. Before installing covers, make sure and secure latch bolts engagement. Adjust strikes if required.
2. Install all device covers and two rod guides in position.  
(See Fig. 14.)

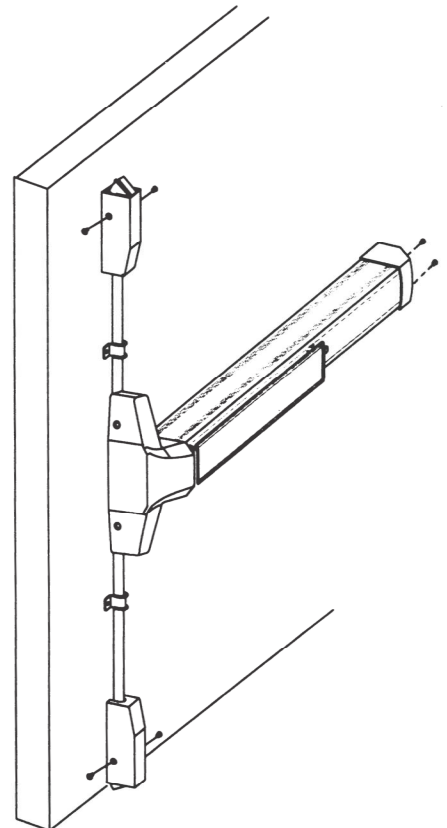
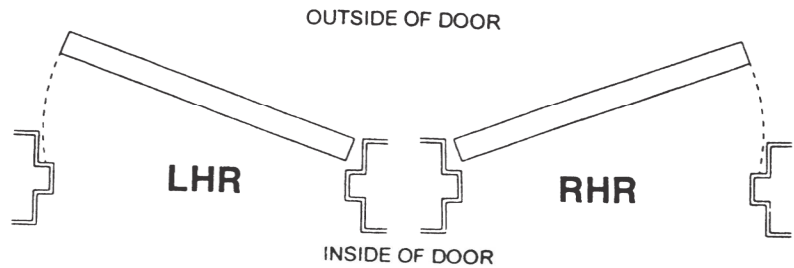

Figure 14

## Door Handing

Use the diagram to determine the hand of door.



### **NOTE :**

***For extending the life of this device, dogging device during high traffic period of the day (Panic device only).***

#### **Dogging:**

Depress push bar,  
insert dogging wrench  
and turn clockwise 15°

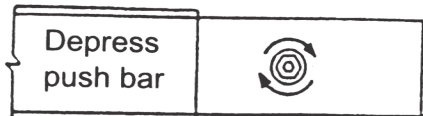

The push bar will remain pressed and the latches will keep retracted.

#### **Release dogging:**

Depress push bar,  
insert dogging wrench and  
turn counter-clockwise 15°

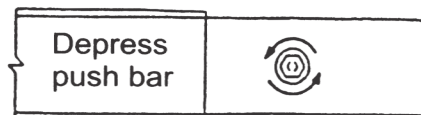

The push bar will return to up position and the latches will project to lock the door.

Dogging wrench

