

1. MARK DOOR

Mark height line on door edge.

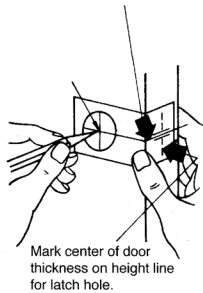

2. BORE TWO HOLES

Bore 1 1/2" hole from both sides of door.

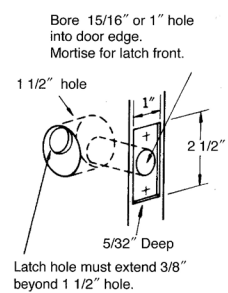

3. INSTALL STRIKE

Mark jamb exactly opposite center of latch hole. Bore two 15/16" holes 5/16" above and below height line to a depth of 1 1/8" depending on bolt projection.

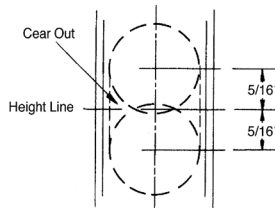

MORTISING FOR DEADBOLT STRIKE

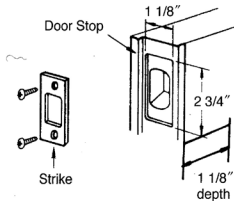

4. INSTALL LATCH

DEADBOLT
Install Latch with word "UP" on body pointing up(UP). Fasten frontplate with two screws. Make sure that the bolt is fully extended out from the door.

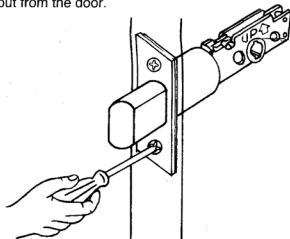

5. INSERT CYLINDER AND TRIM

With key removed, insert cylinder into ring, driver bar into the vertical slot in the latch and slide thumbturn over driver bar. Insert the holding screws through holes in inside rose with thumbturn in vertical position. Assemble inside rose so that holding screws pass through holes in the latch. Tighten screws with screwdriver.

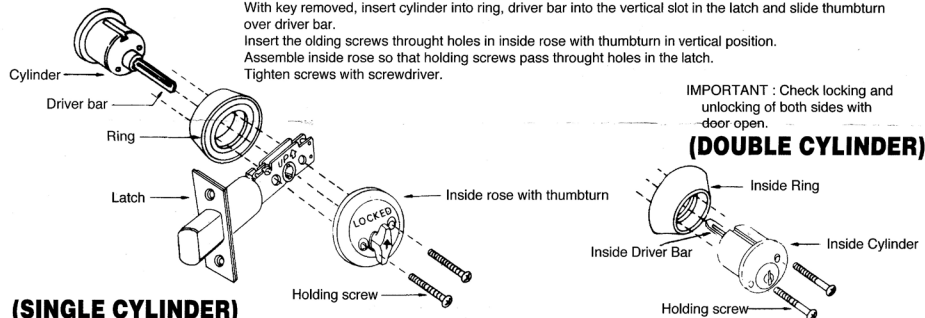

※ SPECIAL INSTRUCTIONS :

- When a double cylinder lock is supplied with special tailpieces shown below, break off both tailpieces along the cut-off line for 1-3/8" (35mm) thickness door.

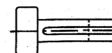

- For standard tailpieces, it will not apply

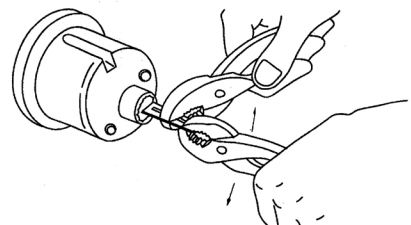

Not to Scale