

- . Up To 100kg Door Weight
- . For 35~45mm Thickness Wooden Door
- . Door Width : 730~1100mm
- . Door Height : <2300mm

Installing Tools

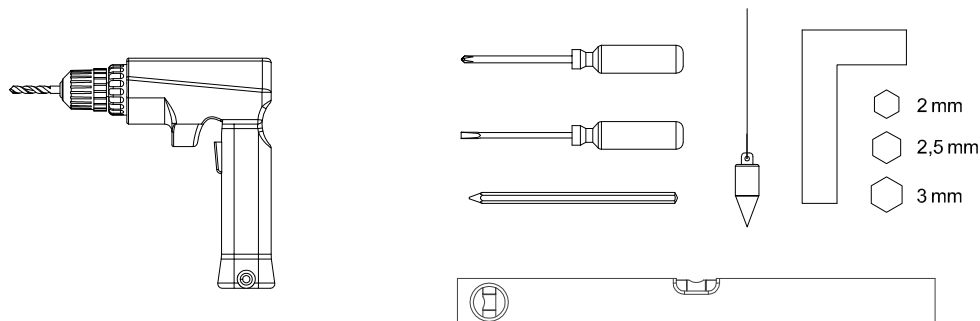

Not to Scale

The use of non-clutching impact drivers to install this hardware will automatically void the warranty.

SDS-U01A Installation Instruction For Wood Door Option 1

Accessories

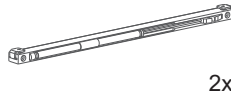
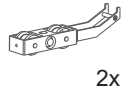

Installation of track rail

1

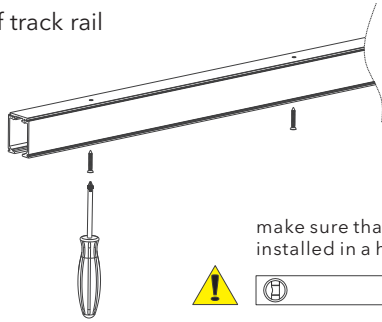

make sure that the track rail is installed in a horizontal position



Installation of door guide

6

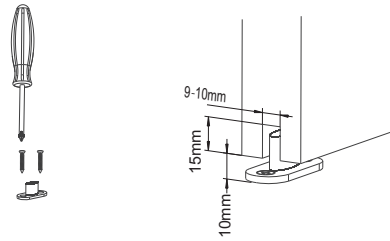

Installation of track roller

2

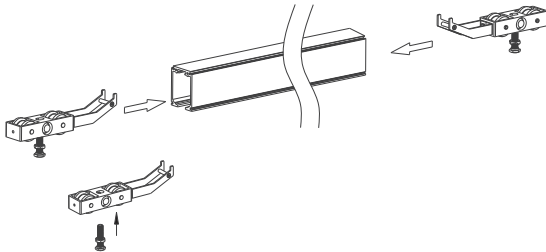

Installation on door

7

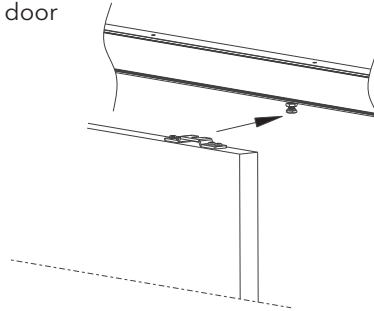

Installation of soft close

3

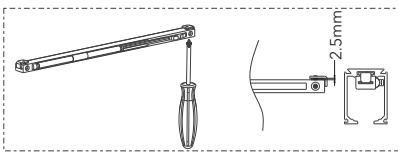

Open status

Open status

Adjustment and fastening of door

8

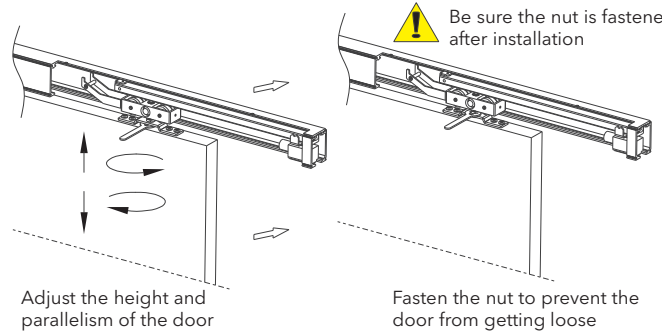

Installation of door stop

4

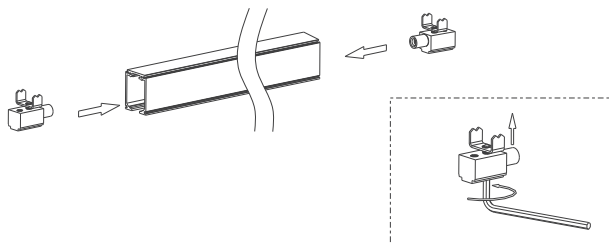

Adjustment and fixation of soft close

9

fasten the soft close after confirm the position of door

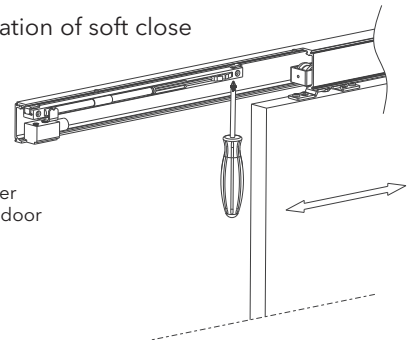

Installation of easy clamp

5

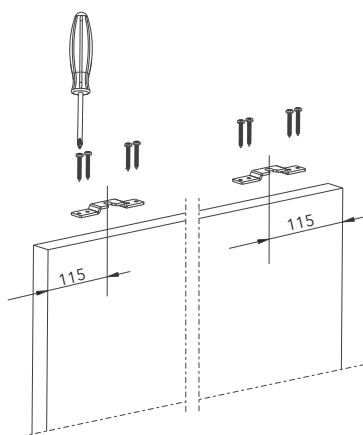

Adjustment and fixation of door stop

10

Correct position

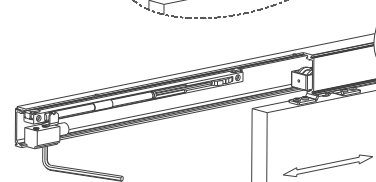
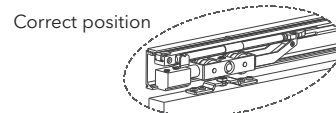

Move the door, then fasten the door stop both ends

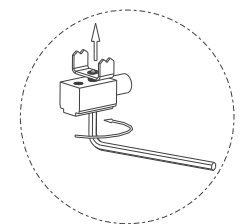

In order to prolong the soft close's service life, pre-limit the door stop 2-3mm in front of the ultimate reset position of the soft close.

SDS-U01A For Wood Door Option 2 with soft closing feature

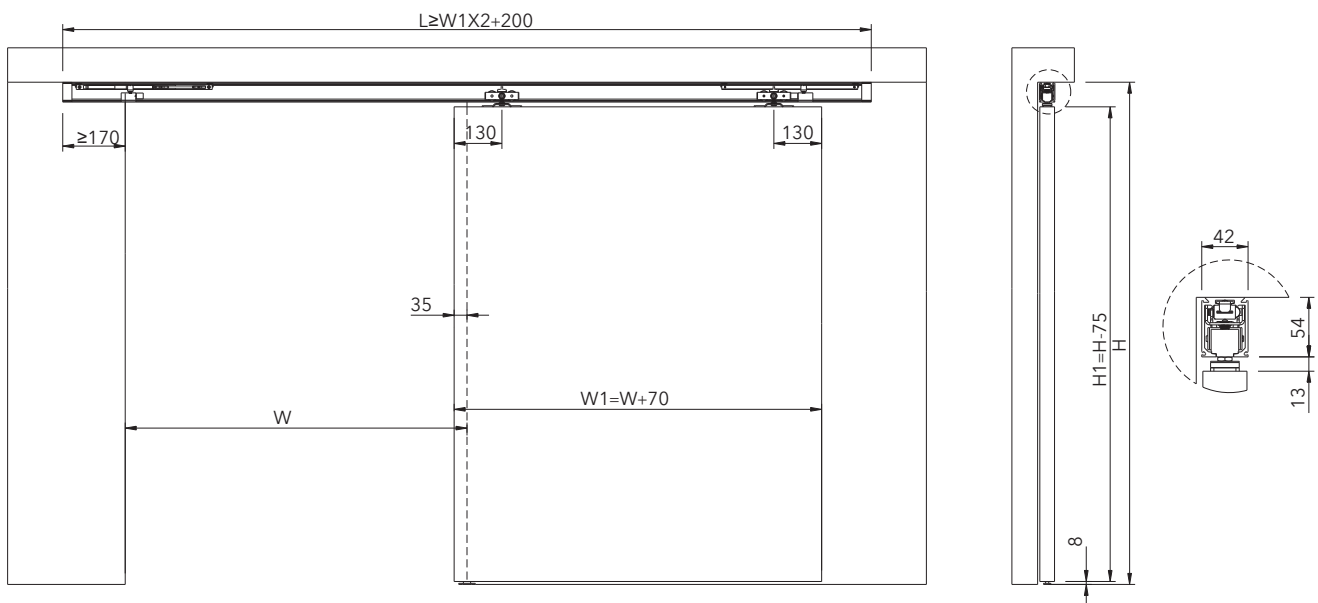

- . Up To 100kg Door Weight
- . For 35~45mm Thickness Wooden Door
- . Door Width : 730~1100mm
- . Door Height : <2300mm

Installing Tools

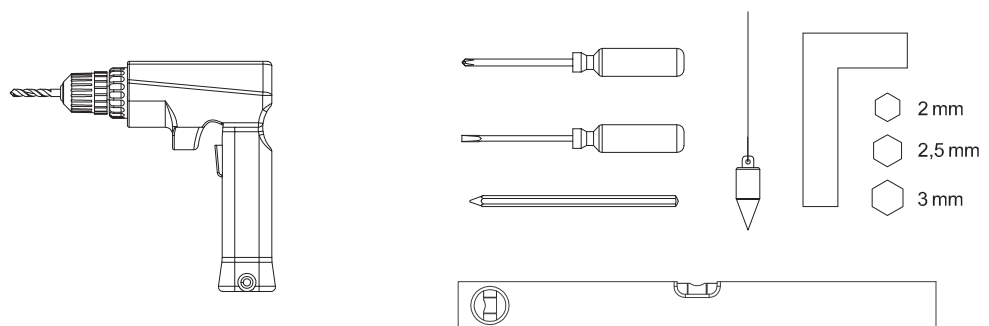

SDS-U01A Installation Instruction For Wood Door Option 2

Accessories

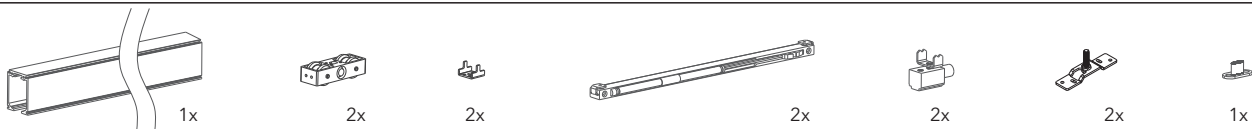

Installation of track rail

1

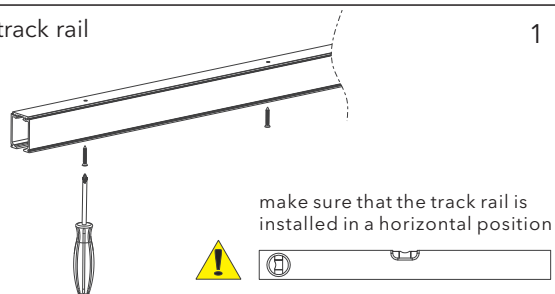

Installation of door guide

6

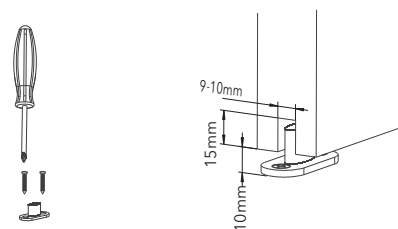

Installation of track roller

2

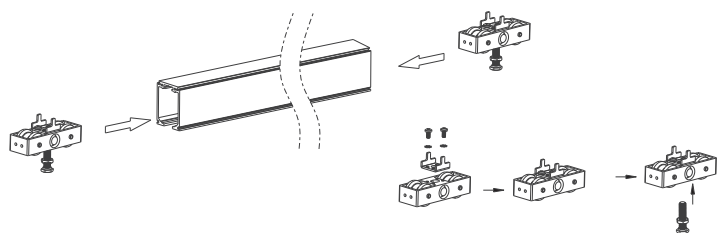

Installation on door

7

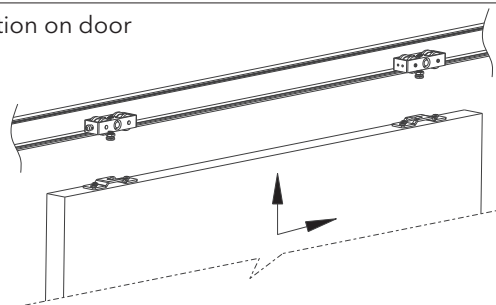

Installation of soft close

3

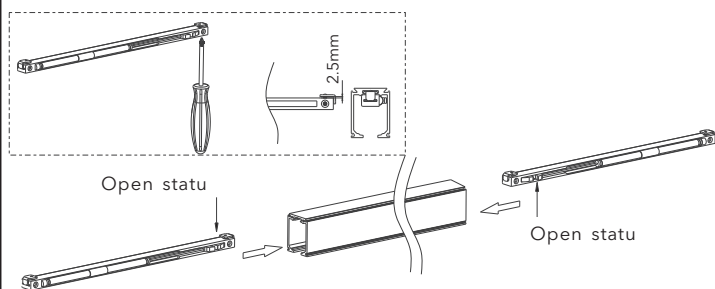

Adjustment and fastening of door

8

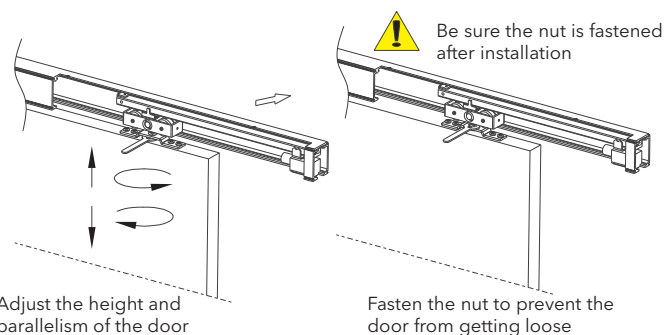

Installation of door stop

4

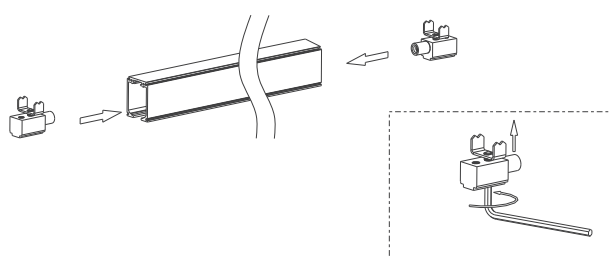

Adjustment and fixation of soft close

9

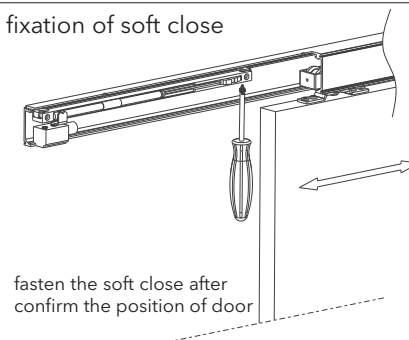

Installation of easy clamp

5

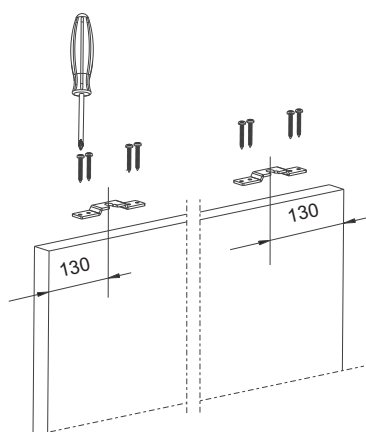

Adjustment and fixation of door stop

10

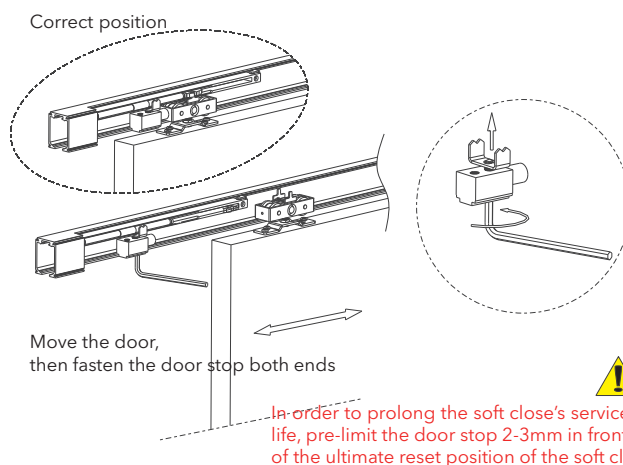

SDS-U01A For Wood Door Option 3 without soft closing feature

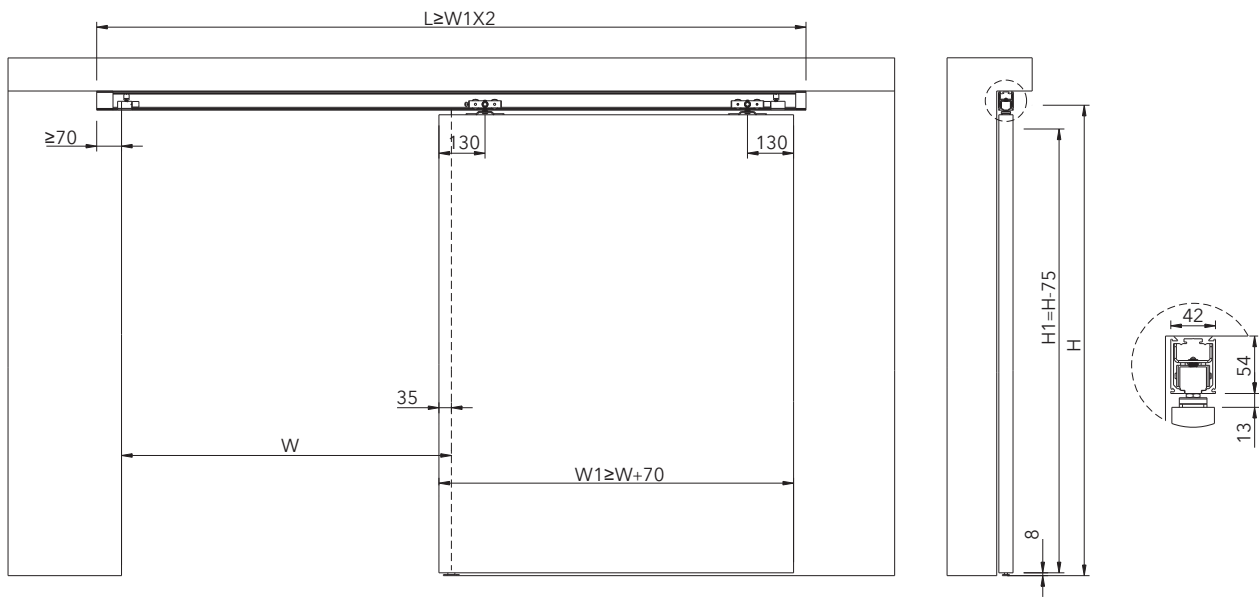

- . Up To 100kg Door Weight
- . For 35~45mm Thickness Wooden Door
- . Door Width : 730~1100mm
- . Door Height : <2300mm

Installing Tools

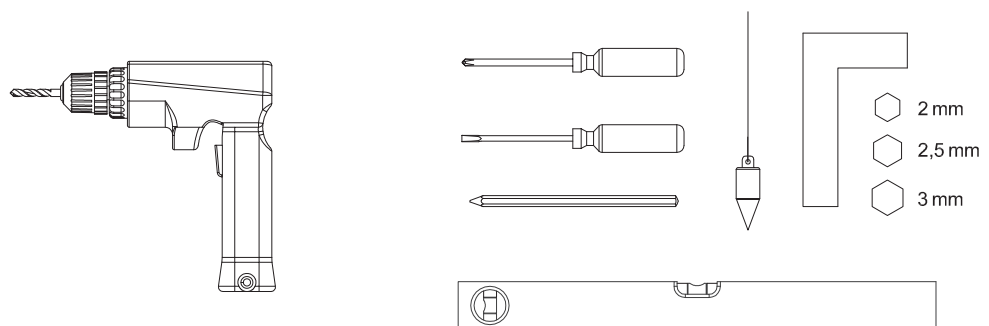

SDS-U01A/B Installation Instruction For Wood Door Option 3

Accessories



1x



2x



2x



2x



2x



1x

Installation of track rail

1

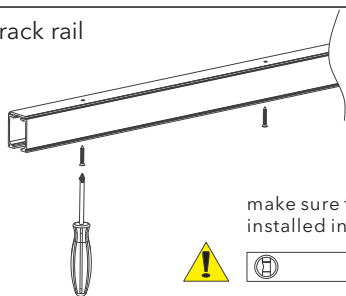

make sure that the track rail is installed in a horizontal position



Installation of track roller

2

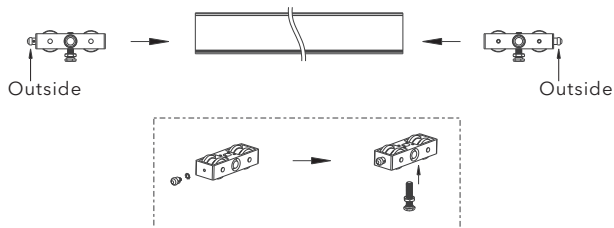

Installation of door stop

3

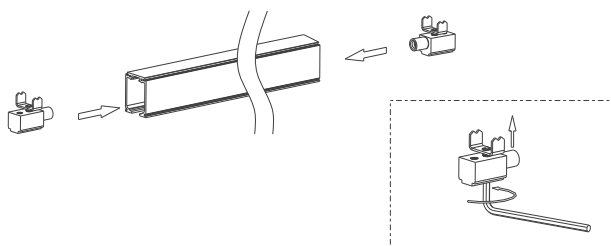

Installation of easy clamp

4

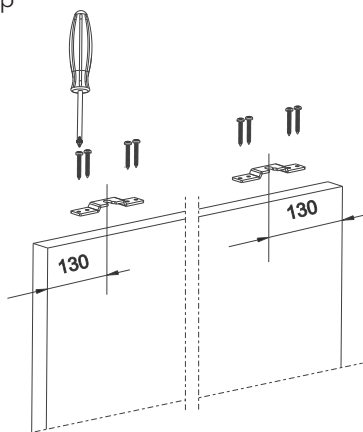

Installation of door guide

5

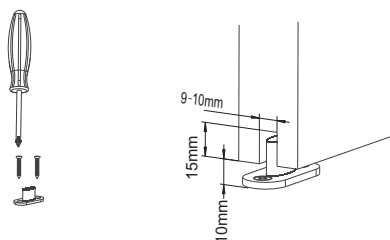

Installation on door

6

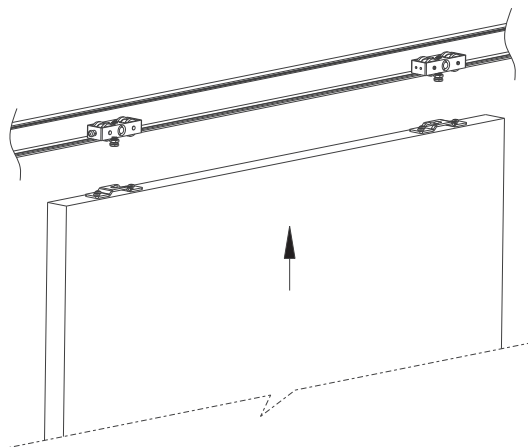

Adjustment and fastening of door

7

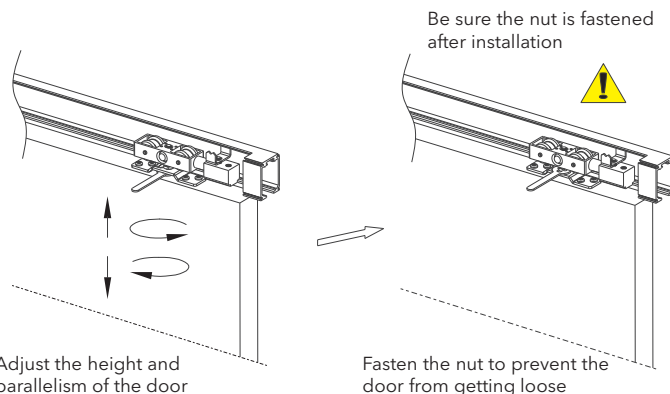

Adjustment and fixation of door stop

8

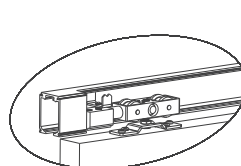
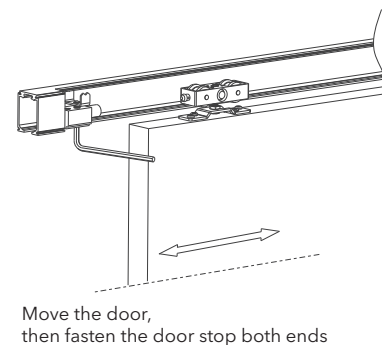

Correct position

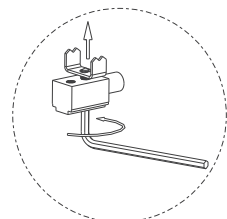

In order to prolong the soft close's service life, pre-limit the door stop 2-3mm in front of the ultimate reset position of the soft close.

SDS-U01A For Glass Door Option 1 with soft closing feature

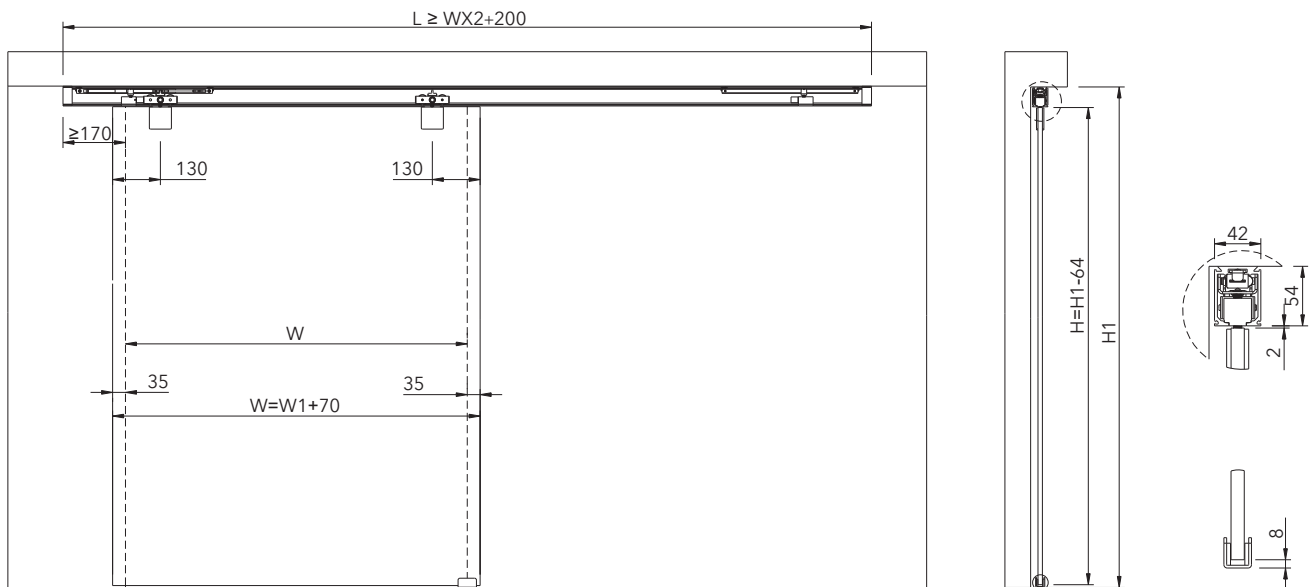

- . Up To 100kg Door Weight
- . For 10~12mm Thickness Glass Door
- . Door Width : 730~1100mm
- . Door Height : <2300mm

Installing Tools

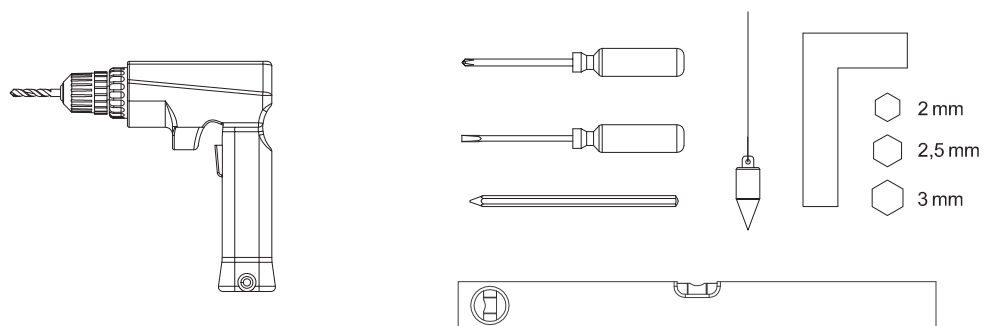

SDS-U01A Installation Instruction For Glass Door Option 1

Accessories

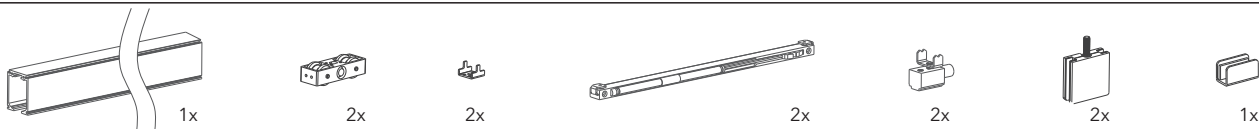

Installation of track rail

1

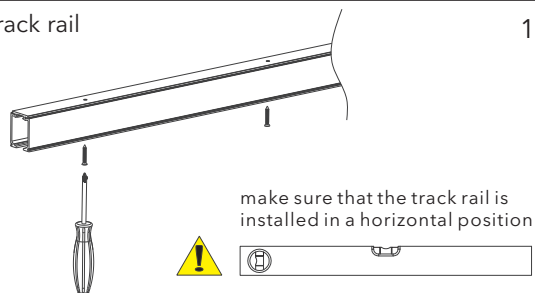

Installation of door guide

6

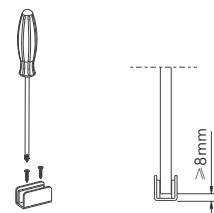

Installation of track roller

2

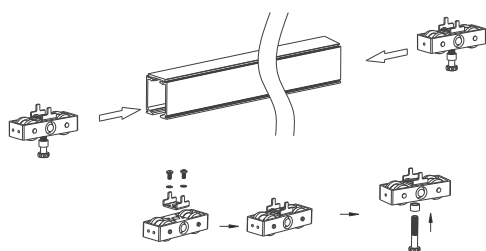

Installation on door

7



In order to avoid the dropping of door, be sure to confirm that the steel ring is placed into the glass clamp after installation.

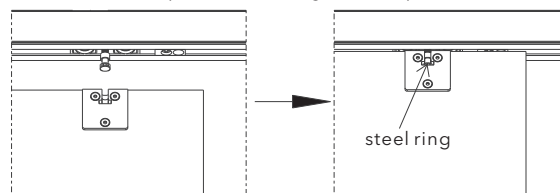

Installation of soft close

3

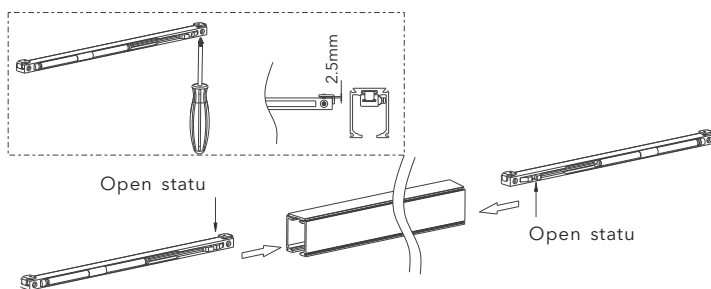

Adjustment and fastening of door

8

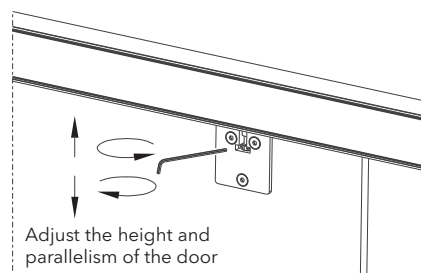

Installation of door stop

4

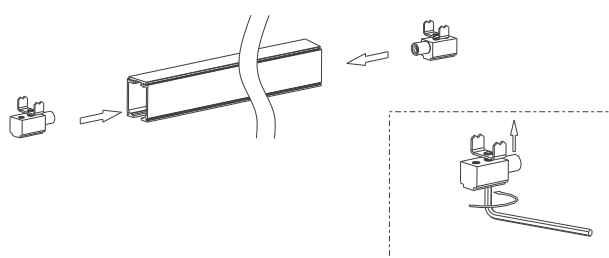

Adjustment and fixation of soft close

9

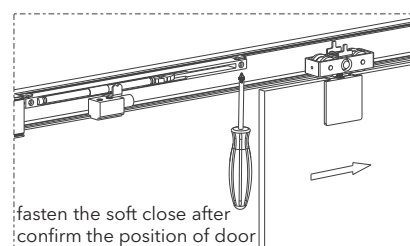

Installation of glass clamp

5

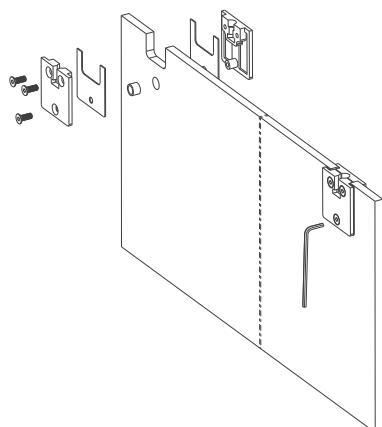

Adjustment and fixation of door stop

10

Correct position

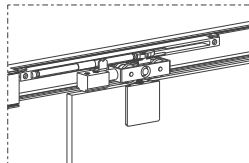

In order to prolong the soft close's service life, pre-limit the door stop 2-3mm in front of the ultimate reset position of the soft close.

Move the door, then fasten the door stop both ends

